



**PROJECT:**

**PROPOSED (G+4) STORIED RESIDENTIAL CUM COMMERCIAL BUILDING PLAN  
AT L.R. DAG NO. - 24006, 24008 & 24009 L.R. KHATIAN NO. - 62808, J.L. - 14,  
MOUZA - BALLY, P.S. - BALLY, DIST. - HOWRAH UNDER BALLY GRAM  
PANCHAYET.**

**APPLICANT: DEBASHIS CHATTERJEE (OWNER)**

**LATITUDE : 22°38'48.96"N**

**LONGITUDE : 88°20'20.10"E**

**LATITUDE & LONGITUDE HAS BEEN MEASURED NEAR THE CENTER OF THE PLOT.**

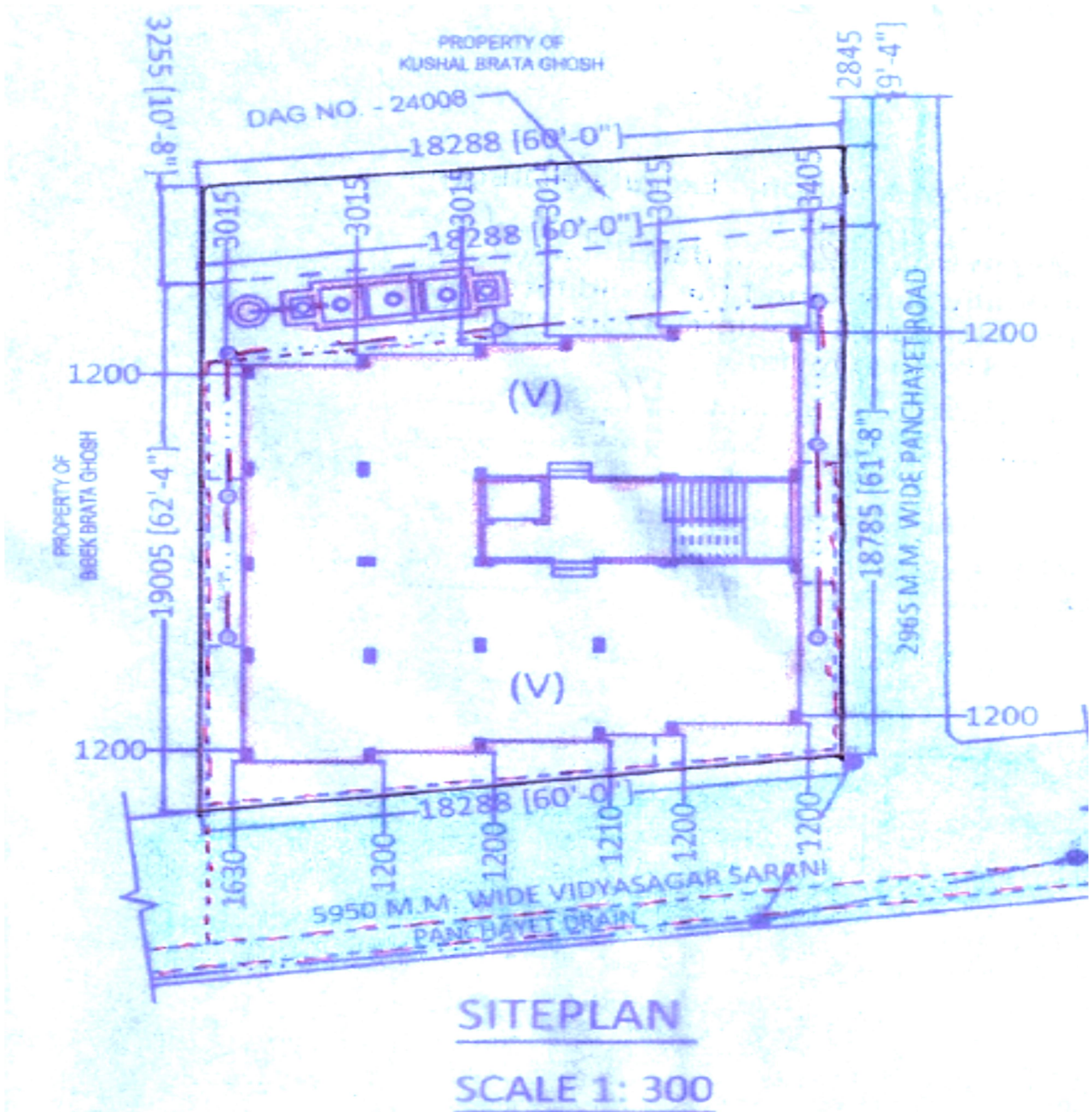

M/S. T. M. AGENCY

*Debas Chatterjee*  
Proprietor